

REVISIONS			
REV.	DESCRIPTION	DATE	REVISED BY

ROHS

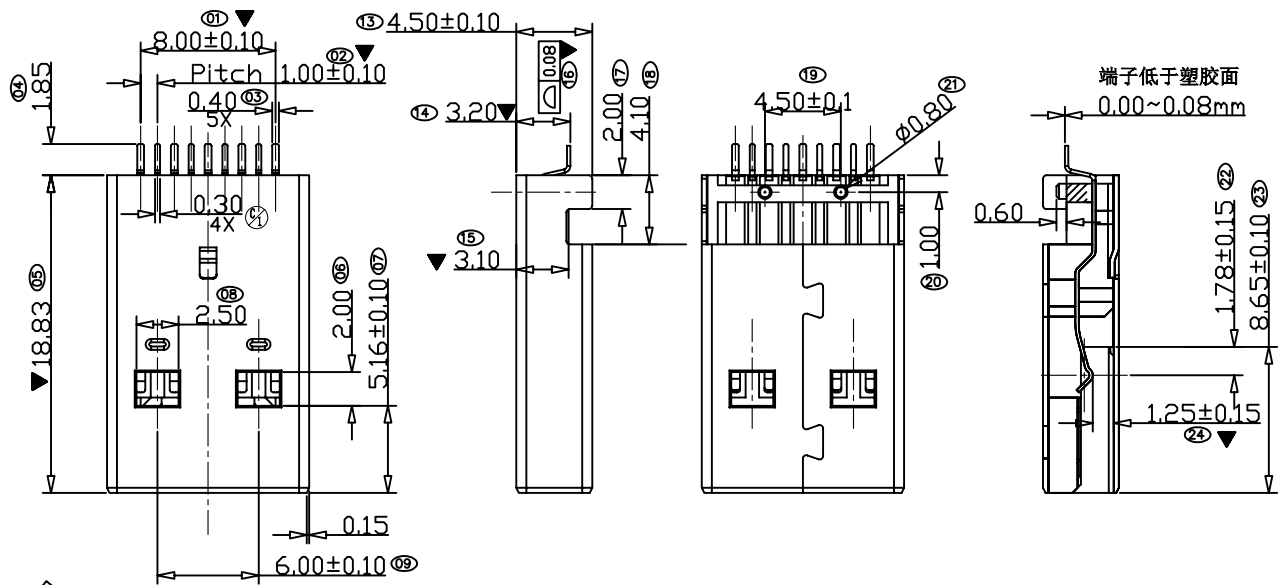

- NOTE:
- MATERIAL:
 - INSULATOR: LCP UL 94V-0
 - CONTACT: BRONZE (T=0.20mm)
 - SHELL: SPCC (T=0.30mm)
 - ELECTRICAL CHARACTERISTICS:
 - CONTACT RESISTANCE: 30mΩ MAXIMUM
 - CONTACT CURRENT RATING: 1.5 AMPERES
 - DIELECTRIC WITHSTANDING VOLTAGE: 500 V R.M.S.
 - INSULATION RESISTANCE 1000 MEGOHMS MIN
 - OPERATING TEMPERATURE: -40° C ~ 85° C
 - MECHANICAL CHARACTERISTICS:
 - MATING FORCE: 3.57kg MAX
 - UNMATING FORCE: 1.02kg MIN
 - DURABILITY: MANDATORY: 5,000 CYCLES

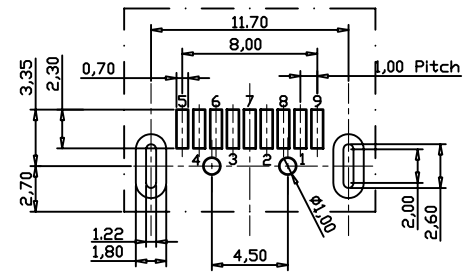
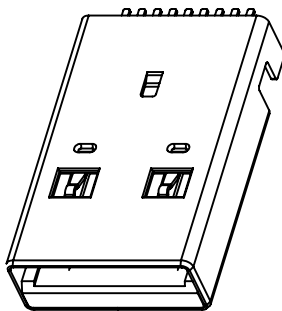
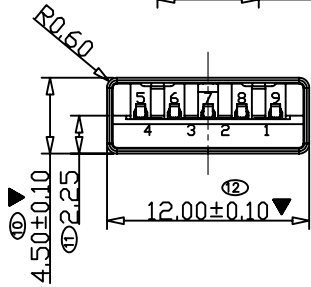

LAYOUT P.C.B

Pin NUMBER	SIGNAL NAME
1	VBUS
2	D-
3	D+
4	GND
5	StdA_SSRX-
6	StdA_SSRX+
7	GND_DRAIN
8	StdA_SSTX-
9	StdA_SSTX+
Shell	Shield

EBE
EBE TECHNOLOGY(HK) LIMITED

GENERAL TOLERANCE		Description	USB3.0 AM SMT		Third Angle Projection	
X. ±0.20	X° ±2°	Customer Name	Drawing By	裴智程		
X.X ±0.15	X.X° ±1°	Customer No.	Designed By	王超		
X.XX ±0.13	X.XX° ±0.5°	Produce No.	Approved By	许代略	Units	■ MM
Date		2011.08.12	Scale			□ Inch